



## NVU TOGGLE PANELS SINGLE-DIN RGB LIGHTING



## TOGGLE PANEL INSTALLATION

### BEFORE YOU BEGIN:

All NVU toggle switches are designed to install seamlessly in your vehicle's interior. The standard size is the same as a standard DIN size radio, can be installed in a 7"x2" opening, or 2 panels for double-DIN applications.

**Wiring:** All NVU toggle switches are rated at 15A 12V. For accessories requiring additional power, a relay must be used.

**FUSES:** See your accessory installation instructions for proper fuse amperage. NVU toggle switches are not fused. Power vs. ground: Each NVU toggle switch is individually wired and can be installed for a power or ground on/off connection. Each switch is rated at 15A up to 250V. For larger circuits we recommend using a relay.

**Lighting:** All panels are RGB LED backlit. SEE THE LIGHTING PAGE FOR ADDITIONAL INFO.

**Connections:** Included are standard ¼" blade terminals. Use proper crimping tools for a good connection.

Each kit includes ON-OFF switches, momentary on-off-momentary –on switches are also available for 2 way accessories like windows, winches, etc. for a complete custom panel. **ICONS/text installation:** Each icon or text insert is sized to tightly fit in each opening. Can be installed in any position needed. Remove adhesive backing, insert into panel and secure by pressing lightly around the perimeter. Additional icons and text call outs are available.

### INSTALLATION:

Select a suitable location for your panel to be installed. Refer to the instruction sheet on the back of this sheet for dimensions. Check for proper clearance behind the panel.

Cut the required 7"x2" hole for panel installation. The standard fasteners included in the kit are 8-32, use the appropriate size drill bit as needed.

Wire as needed, it is best practice to communize all power and ground leads.

Secure panel in place, wire in lighting.

### INSERTS:

Your panel included a set of universal inserts to labelling each position. Carefully remove the protective film on the front and the adhesive backer on the back. Carefully place in desired position and press down. We make these a rectangle to help you keep the straight and lined up properly.



## RGB LIGHTING

The image below depicts the rear of your toggle panel. The two spade connectors are for powering the lights. If your instrument/interior light circuit (on a dimmer) does not operate the lighting properly, we suggest wiring into your parking lamp circuit for constant power when on, your factory dimmer may not support LED lighting. The Lighting circuit is designed for 12V systems. May be used on 24V systems by adding a 470  $\Omega$  resistor in the power feed line. All of the LEDs are linked together and change at the same time, there is not a provision for individual cavity lighting.

### DIP-SWITCH LIGHT COLOR SELECTION

### POWER FEED (12V+) FROM SWITCH OR SOURCE

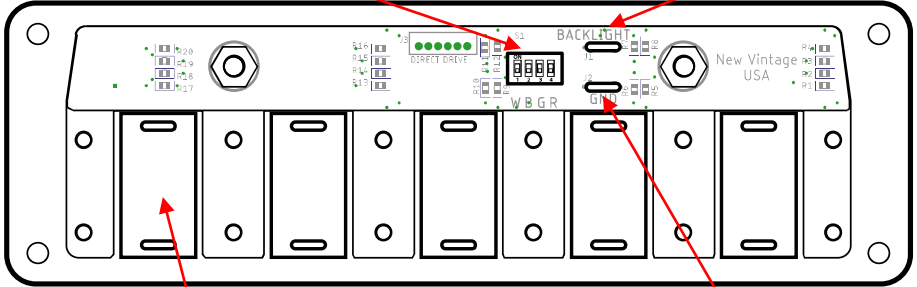

EACH TOGGLE SWITCH IS INDIVIDUALLY WIRED

GROUND FOR LIGHTS

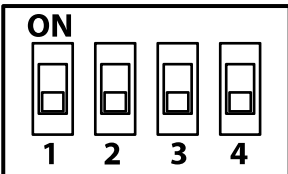

### DIP SWITCH

The DIP-switch has 4 switches, R.G.B and #1 is pure white. Move the switches to the desired positions per the cart below to achieve the color you prefer.

COLOR	1	2	3	4
WHITE	ON	OFF	OFF	OFF
BLUE	OFF	ON	OFF	OFF
GREEN	OFF	OFF	ON	OFF
RED	OFF	OFF	OFF	ON
CYAN	OFF	ON	ON	OFF
YELLOW	OFF	OFF	ON	ON
MAGENTA	OFF	ON	OFF	ON
MINT	ON	OFF	ON	OFF
INCANDESCENT	ON	OFF	ON	ON
BRIGHT WHITE	ON	ON	ON	ON
PINK	ON	OFF	OFF	ON
LIGHT BLUE	ON	ON	OFF	OFF

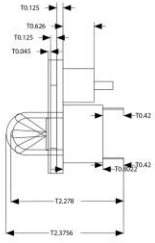
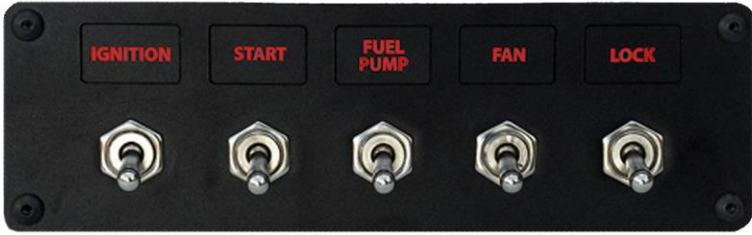

ALL DIMENSIONS IN INCHES

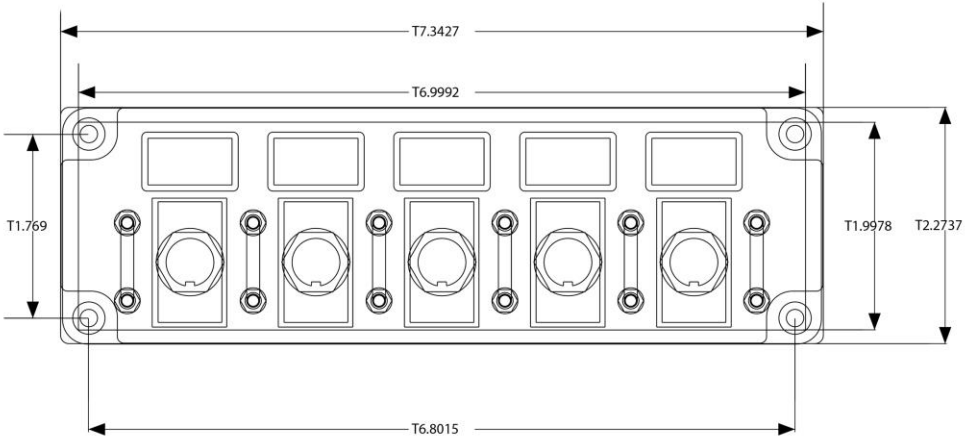

NEW VINTAGE USA  
 21840 WYOMING PL STE. A  
 OAK PARK, MI 48237  
 VOICE: 248.850.5482  
 FAX: 248.565.8291

[www.newvintageusa.com](http://www.newvintageusa.com)  
[service@newvintageusa.com](mailto:service@newvintageusa.com)