

INSTRUCTIONS

© 2024, Speedway Motors, Inc.



910-310311 - Self-Canceling Turn Signal Conversion Kit

Kit Contents	
Part #	Description
910310311.1	Column Clamp Collar
910310311.2	Turn Signal Switch
910310311.3	Hub, Self-Canceling
910310311.4	Hardware Kit

This kit is designed to add a self-canceling turn signal function to an existing Speedway Motors Street Rod type steering column.

Note: This switch is designed for vehicles with separate rear turn signal lamps. To use taillights that combine the stop and turn signal features, you'll need a Trailer Taillight Conversion module for proper functionality and seamless integration. This part is not available at Speedway Motors, but can be sourced at a local trailer supply, camping, home improvement store, or some other auto parts stores.

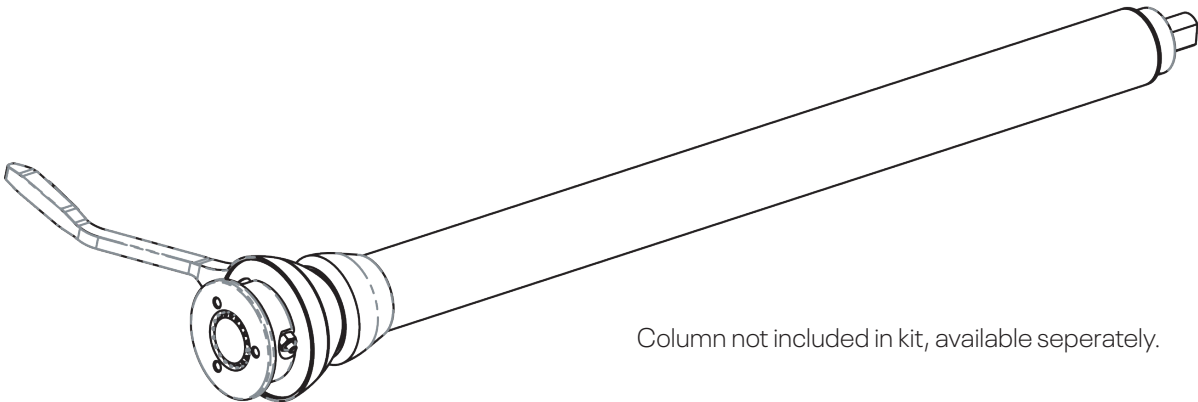

Column not included in kit, available separately.

1. Begin by modifying the existing column assembly. This involves shortening the column tube by 1". Carefully mark and cut the tube 1" from the end using a piece of tape wrapped around the tube as a guide. Cut the tube square and take care not to cut or damage the inner shaft. Deburr and clean the cut end before reassembly. Carefully remove the bearing from the cut off section and clean. Press the bearing back into the shortened tube and replace the shaft ensuring free rotation of shaft in bearings.

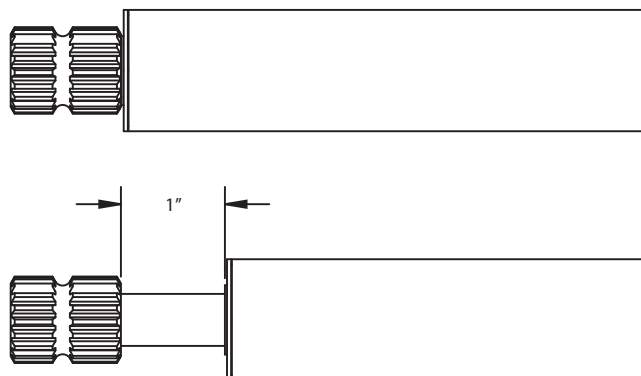

INSTRUCTIONS

© 2024, Speedway Motors, Inc.

SPEEDWAY
motors®

2. Remove the screw and metal retaining plate from the switch assembly and discard the retaining plate as it is not needed for this assembly. Feed the wiring from the turn signal switch through the inner slot in the mounting collar. Align the tab on the collar with the slot in the switch and attach the collar to the switch using the included screw. Do not overtighten the screw to avoid stripping.

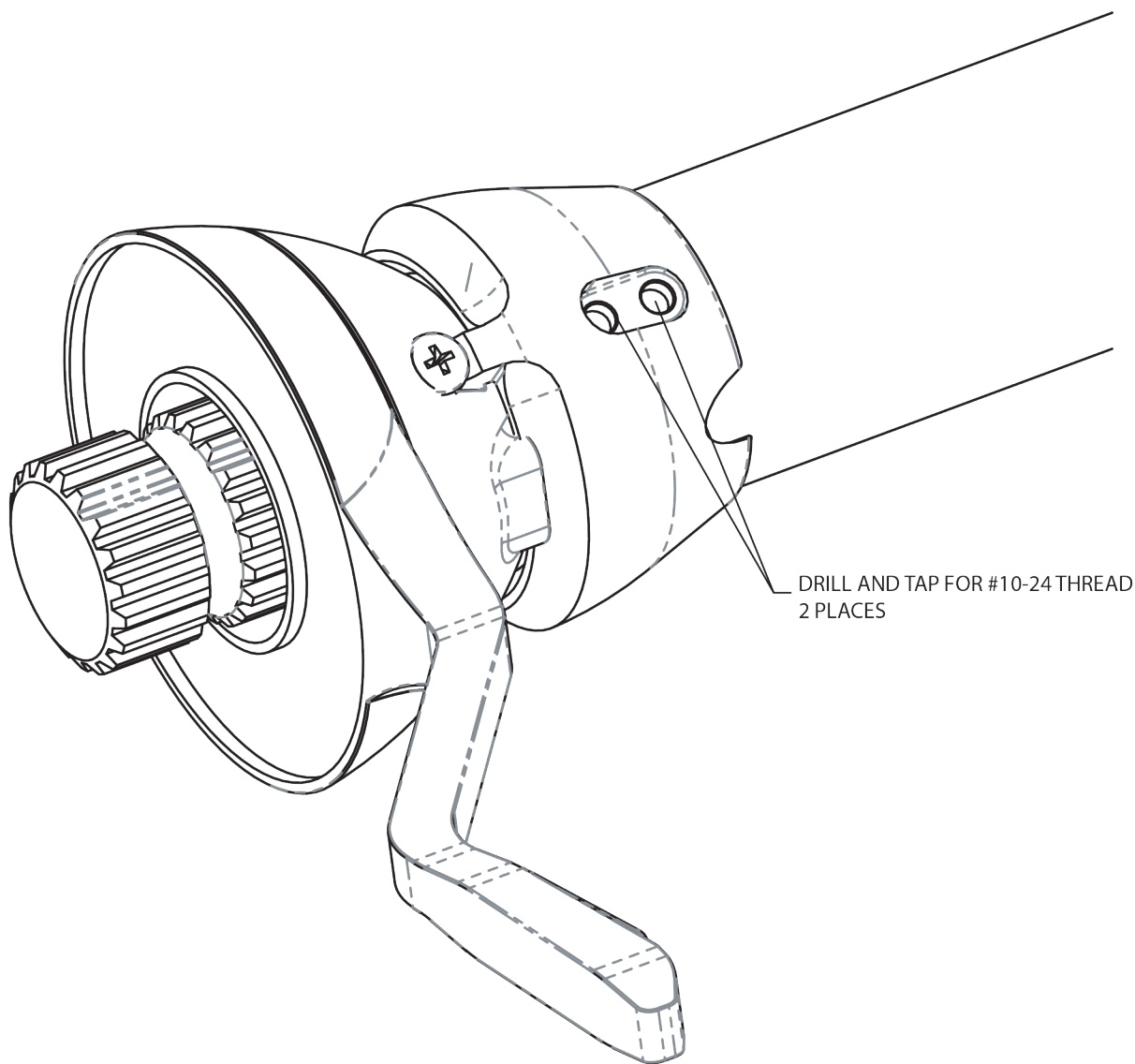

3. Slide the switch/collar assembly over the input end of the column until the switch bottoms on the upper end of the column tube. Mark the 2 holes for the mounting screws on the column tube and remove the switch assembly. Drill and tap the 2 holes for #10-24 thread (do not drill into the shaft). Replace the switch assembly and bolt in place using the supplied #10-24 x .38 socket head cap screws. It is recommended to use thread locker on these screws.

INSTRUCTIONS

© 2024, Speedway Motors, Inc.

SPEEDWAY
motors®

4. Install column assembly in vehicle with turn signal switch arm to left hand side and approximately 5 degrees up from horizontal. Leave lower shaft disconnected from steering box at this time. Mount quick release steering wheel hub on column shaft using included shoulder bolt and lock nut.

5. Install shaft clamp collar at lower end of shaft and adjust so that the column shaft rotates freely. Fully tighten clamp collar to retain shaft in column tube. Rotate hub/shaft assembly until shoulder bolt is horizontal and at top of column – this aligns slots with switch detents to facilitate self-canceling function of switch. Connect output shaft to steering box at this time. Install steering wheel. Rotate steering wheel in both directions with turn signal switch activated to ensure that it cancels and that it is indexed properly to cancel in both directions. Adjust index as required to allow for switch to cancel symmetrically in both directions.

6. Wiring details for this switch are as follows:

Color	
Yellow w/ Red Stripe	Output to right turn bulb(s)
White w/ Red Stripe	Output to left turn bulb(s)
Black w/ Red Stripe	Input from turn signal flasher
Red w/ Black Stripe	Output to turn signal indicator light in dash (tees from black w/red stripe wire above)
Brown	Connect to a solid ground
Brown Jumper	Not used and can be removed
Red	Optional ground for the VW headlight - High/Low feature dimmer relay (relay not included)

***Note:** If your vehicle has both left and right turn signal dash indicators, do not use the Red w/ Black stripe -> Output to turn signal indicator light in dash wire. Instead, tap into the left and right turn output wires for your individual dash indicators.

For use of the momentary headlight High/Low switch:

Use the Red -> Ground for optional VW headlight dimmer relay wire for headlight dimming. This feature requires a VW Headlight Dimmer Relay (5-prong). Part Number 111941583. This relay is not available through Speedway Motors, but can be sourced at multiple VW parts sources and is wired as follows:

- Terminal 56 Power from the headlight switch
- Terminal 56a Power to the high beam headlamps
- Terminal 56b or "F" Power to the low beam headlamps
- Terminal 30 Power from 56 terminal (jumper wire)
- Terminal S Momentary ground from turn signal switch (red wire)