

INSTRUCTIONS

© 2024, Speedway Motors, Inc.

SPEEDWAY
motors®

910-89671.1 - SoloSwap™ T56 Main Case Transmission Mockup

Kit Contents			
Qty	Part #	Description	Item #
1	91089671.1.1	Bellhousing Mount	1
1	91089671.1.2	Mid Plate, 1st Section	2
1	91089671.1.3	Mid Plate, 2nd Section	3
1	91089671.1.4	Mount, Tail Housing	4
1	91089671.1.5	Plate, Top	5
1	91089671.1.6	Plate, Bottom	6
1	91089671.1.7	Plate, Shifter Location	7
1	91089671.1.8	Plate, Left Side	8
1	91089671.1.9	Plate, Right Side	9

Hardware			
Qty	Description	Tool Size	Item #
9	Serrated Flange Hex Head, Zinc Plated, 1/4-20 x .50	3/8 Hex	H1
9	Serrated Flange Nut, Zinc Plated, 1/4-20	7/16 Hex	H2

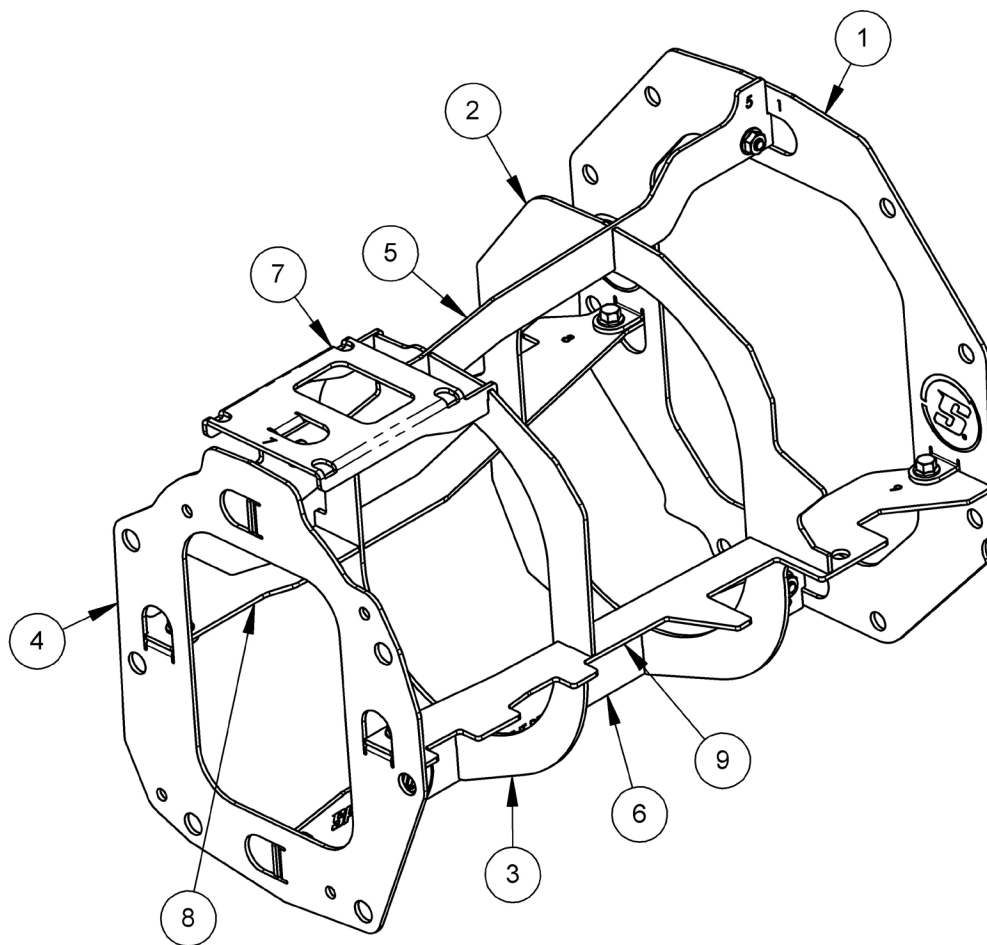

INSTRUCTIONS

© 2024, Speedway Motors, Inc.

SPEEDWAY
motors®

1. Count and ensure that all listed parts in the instructions sheet are supplied.

2. Using the supplied 1/4" hardware, fasten the left side plate (8) to the bellhousing mount plate (1) and tail housing mount plate (4). Leave the bolts finger tight.

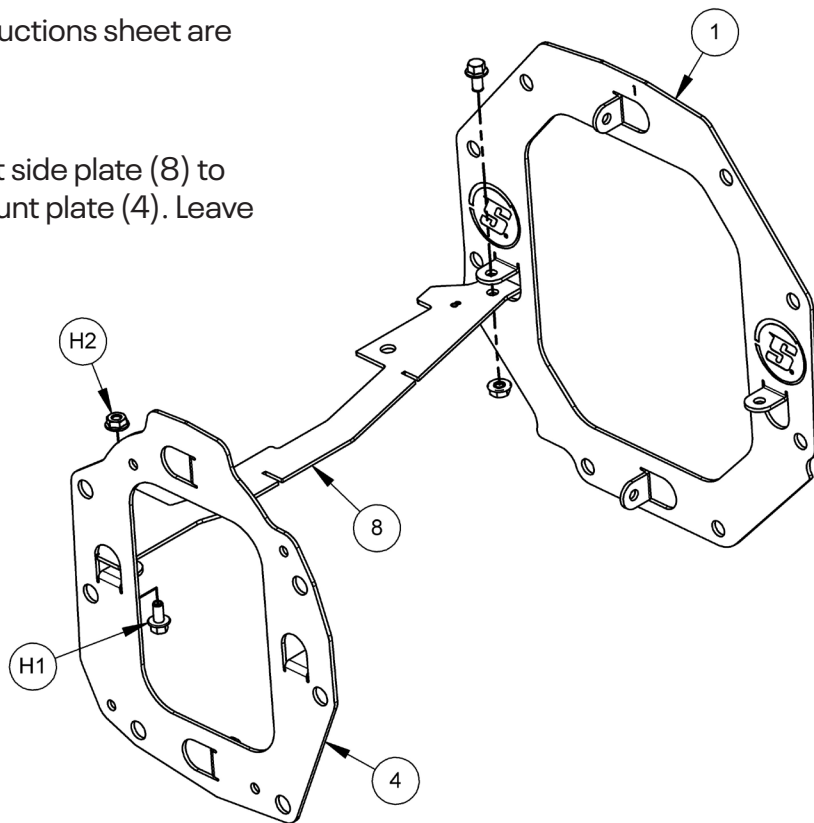

3. Arrange the mid plates (2,3) and right side plate (6) as shown below. Once all parts are in their relative position they can be pushed into their respective slots. Fasten the right side plate (6) to the bellhousing mount plate (1) and tail housing mount plate (4). Leave the bolts finger tight.

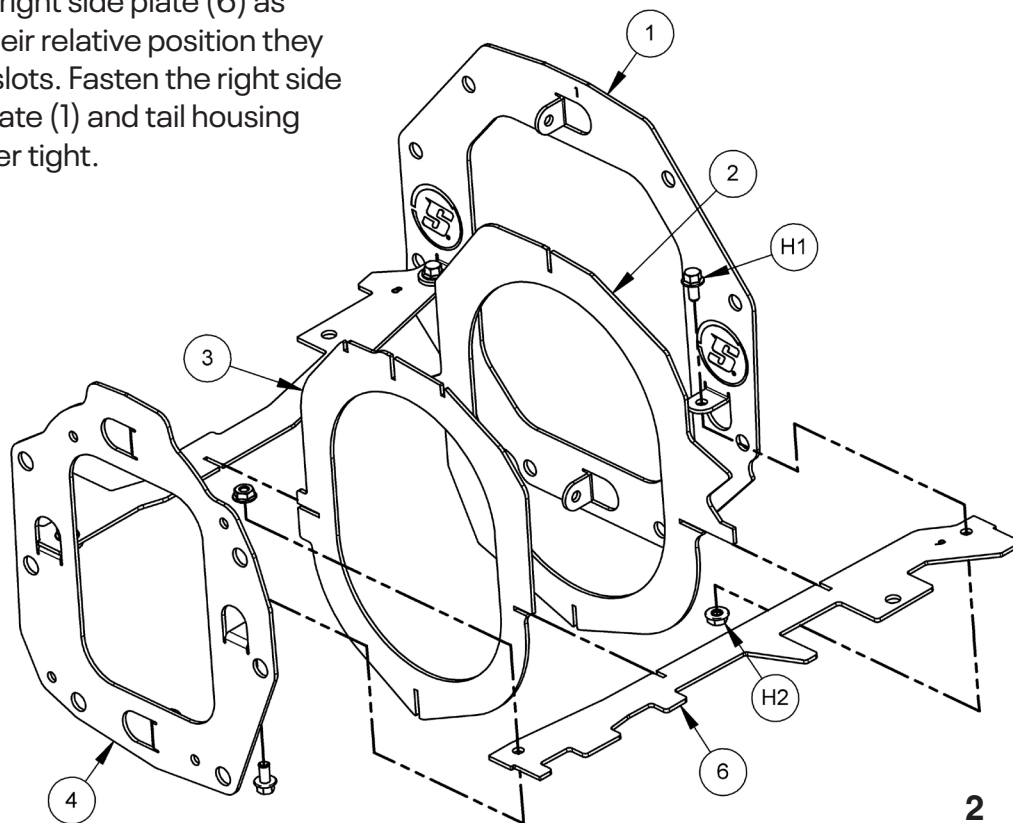

INSTRUCTIONS

© 2024, Speedway Motors, Inc.



4. Place the end of the top plate (5) into the tail housing mount plate (4). Align the with the middle plates (2, 3). Push the top of the bellhousing mount plate (1) out and push the top plate into the slots. Fasten using the 1/4" hardware. Leave the bolts finger tight. Place the end of the bottom plate (6) into the tail housing mount plate (4). Align the with the middle plates (2, 3). Push the bottom of the bellhousing mount plate (1) out and push the bottom plate into the slots. Fasten using the 1/4" hardware. Leave the bolts finger tight.

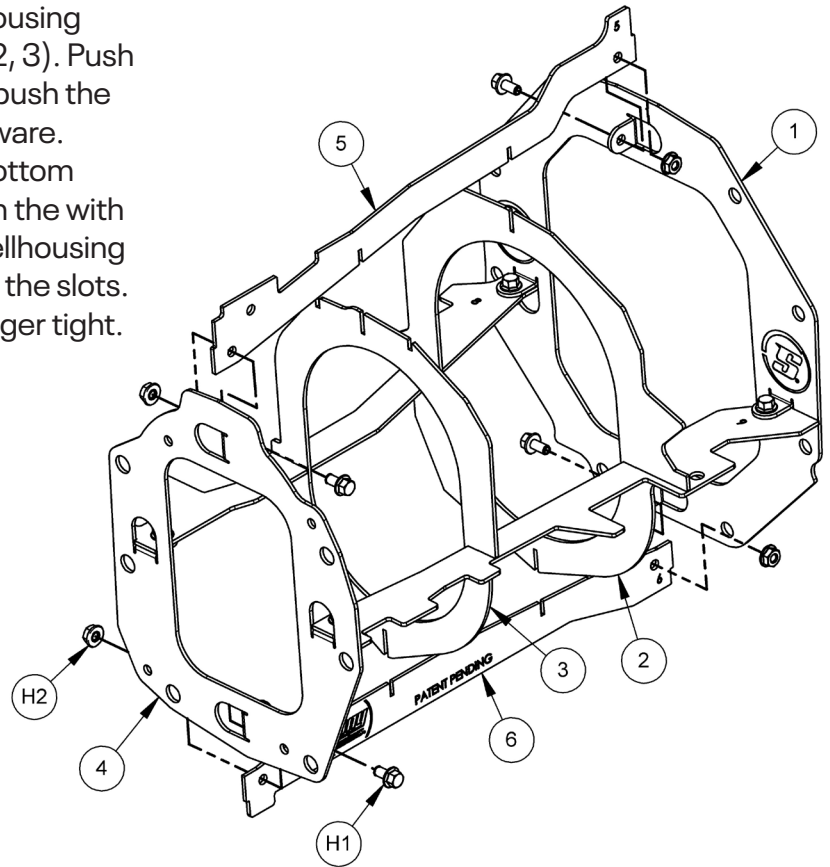

5. Push the shifter location plate (7) into the mid plate (3) slots. Fasten using the 1/4" hardware. Leave the bolts finger tight.

6. Tighten all bolts.

