

INSTRUCTIONS

© 2024, Speedway Motors, Inc.



910-89672 - SoloSwap™ T56 Bellhousing Mockup

Kit Contents			
Qty	Part #	Description	Item #
1	91089672.1	Engine Mount Plate	1
1	91089672.2	Transmission Mount Plate	2

Hardware			
Qty	Description	Tool Size	Item #
6	Serrated Flange Hex Head, Zinc Plated, 5/16-18 x .75"	10mm Hex	H1
6	Serrated Flange Nut, Zinc Plated, 5/16-18	13mm Hex	H2
4	Serrated Flange Nut, Zinc Plated, M10-1.50	15mm Hex	H3

1. Count and ensure that all listed parts in the instructions sheet are supplied.

2. Insert the transmission mount plate (2) in between engine mount plate (1) flanges. Fasten the parts together using the 5/16-18 x 3/4" bolts and nuts through the slots. Leave bolts finger tight.

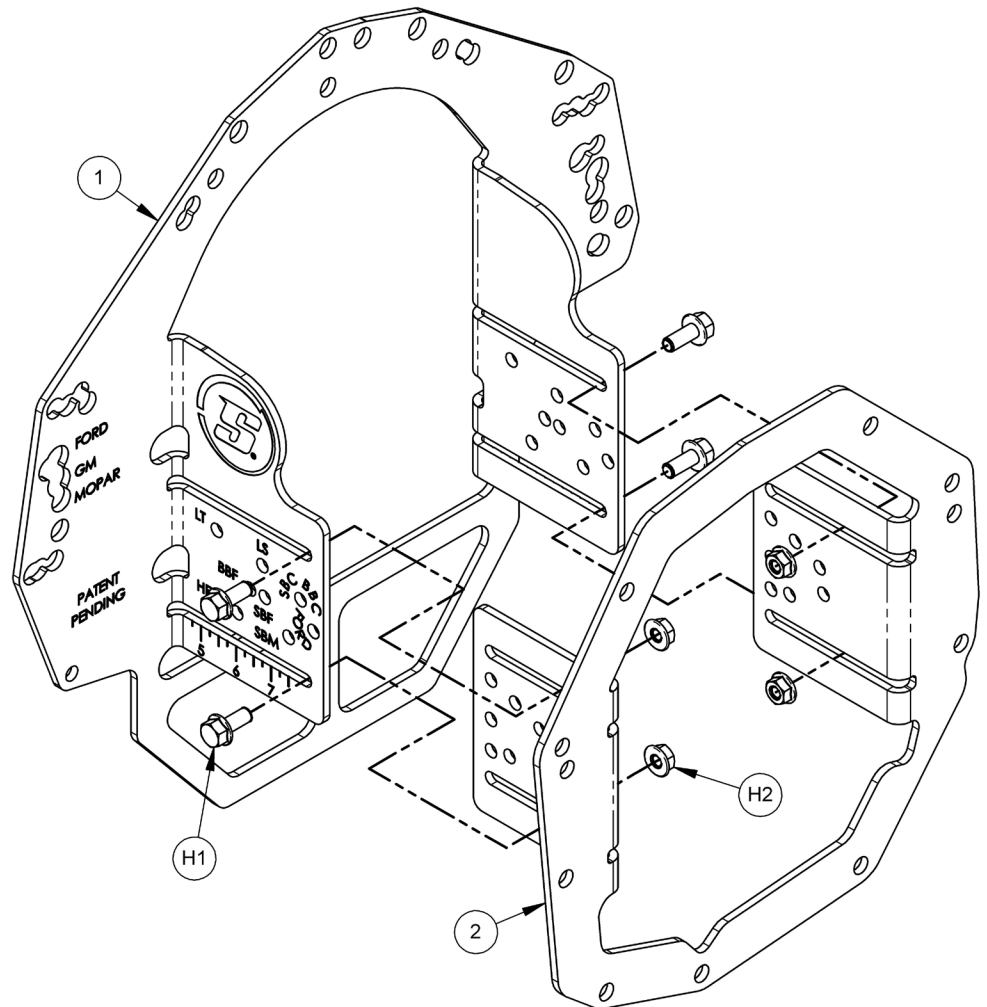

INSTRUCTIONS

© 2024, Speedway Motors, Inc.



3. Determine the bellhousing depth for your application. This can typically be found in the specifications of the bellhousing. The mockup T56 bellhousing does include some preset depths. See the chart below.

4. If using preset holes, install 5/16-18 x 3/4" bolts and nuts through the desired preset holes when aligned. Tighten all bolts.

5. If not using the preset holes, slide the plates in and out until you reach the correct depth. Tighten all bolts.

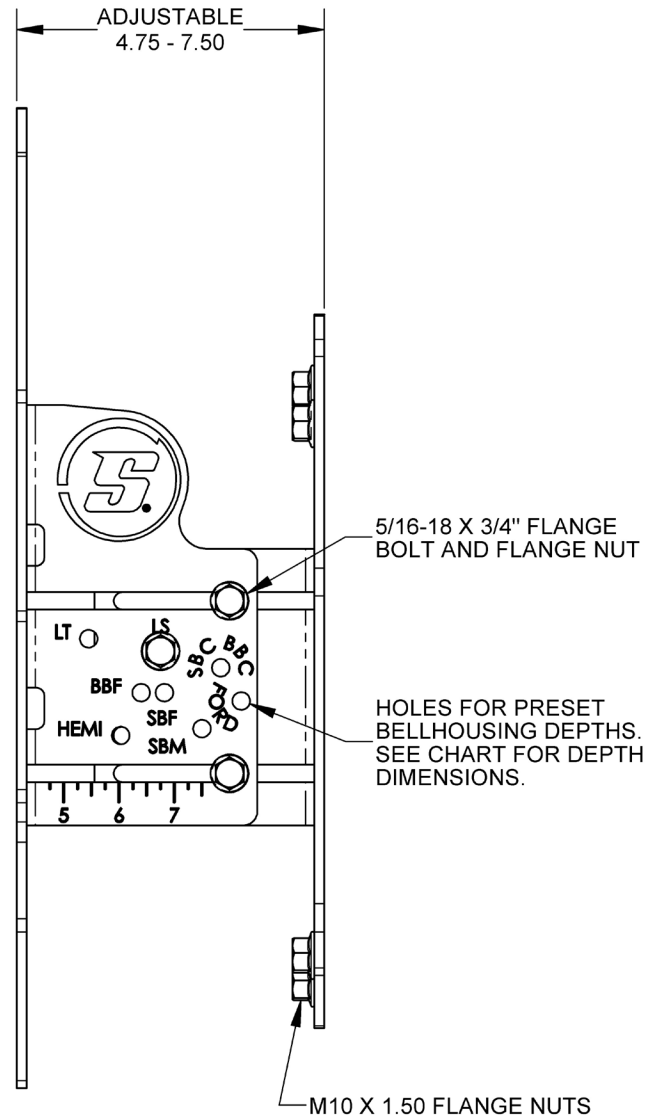

Bellhousing Depth Measurement Guide

Engine Manufacturer	Engine Type	Bellhousing Depth	Fitment Notes
Chevrolet	Small Block Chevy (SBC)	5.95"	Gen I - 265ci to 400ci (1955-1998) / Gen II - LT1/LT4 series (1992-1997)
Chevrolet	Big Block Chevy (BBC)	5.95"	Gen I thru Gen IV 348ci to 496ci (1958 -2010)
Chevrolet	Chevy LS (LS)	5.56"	Gen III - 4.8L to 6.0L (1996-2007) / Gen IV - 5.3L to 6.2L (2005-Present)
Chevrolet	Chevy LT (LT)	4.95"	Gen V - 6.2L (2013-Present)
Ford	Small Block Ford (SBF)	6.32"	SBF - 289/302/351W (1966-2000)
Ford	FE - Big Block Ford (BBF)	5.90"	FE Series - 332ci to 428ci (1958-1976)
Ford	MOD - Modular (FORD)	6.21"	Modular/Coyote/Godzilla - 4.6L to 7.3L (1991-Present)
Chrysler (MOPAR)	Gen II HEMI (HEMI)	5.53"	Gen III HEMI - 5.7L/6.1L/6.4L (2003-Present)
Chrysler (MOPAR)	Small Block Chrysler (SBM)	6.47"	LA Series - 318/340/360 (1967-2002)