

# INSTRUCTIONS

© 2025, Speedway Motors, Inc.



## 910-98230 - TorqLink™ 73-87 C10 Square Body Transmission Crossmember

| Kit Contents |            |                 |        |
|--------------|------------|-----------------|--------|
| Qty          | Part #     | Description     | View # |
| 1            | 91098230.1 | Trans Support   | 1      |
| 1            | 91098230.2 | Height Adjuster | 2      |

| Hardware |   |        |
|----------|---|--------|
| Qty      | Description                                       | Item # |
| 4        | Hex Cap Screw, 7/16-20 x 1-1/4" Long, Zinc Plated | H1     |
| 4        | Nylon Lock Nut, 7/16-20, Zinc Plated              | H2     |
| 4        | Flat Washer, 7/16, Zinc Plated                    | H3     |
| 6        | Hex Cap Screw, 3/8-24 x 1" Long, Zinc Plated      | H4     |
| 6        | Nylon Lock Nut, 3/8-24, Zinc Plated               | H5     |
| 6        | Flat Washer, 3/8, Zinc Plated                     | H6     |

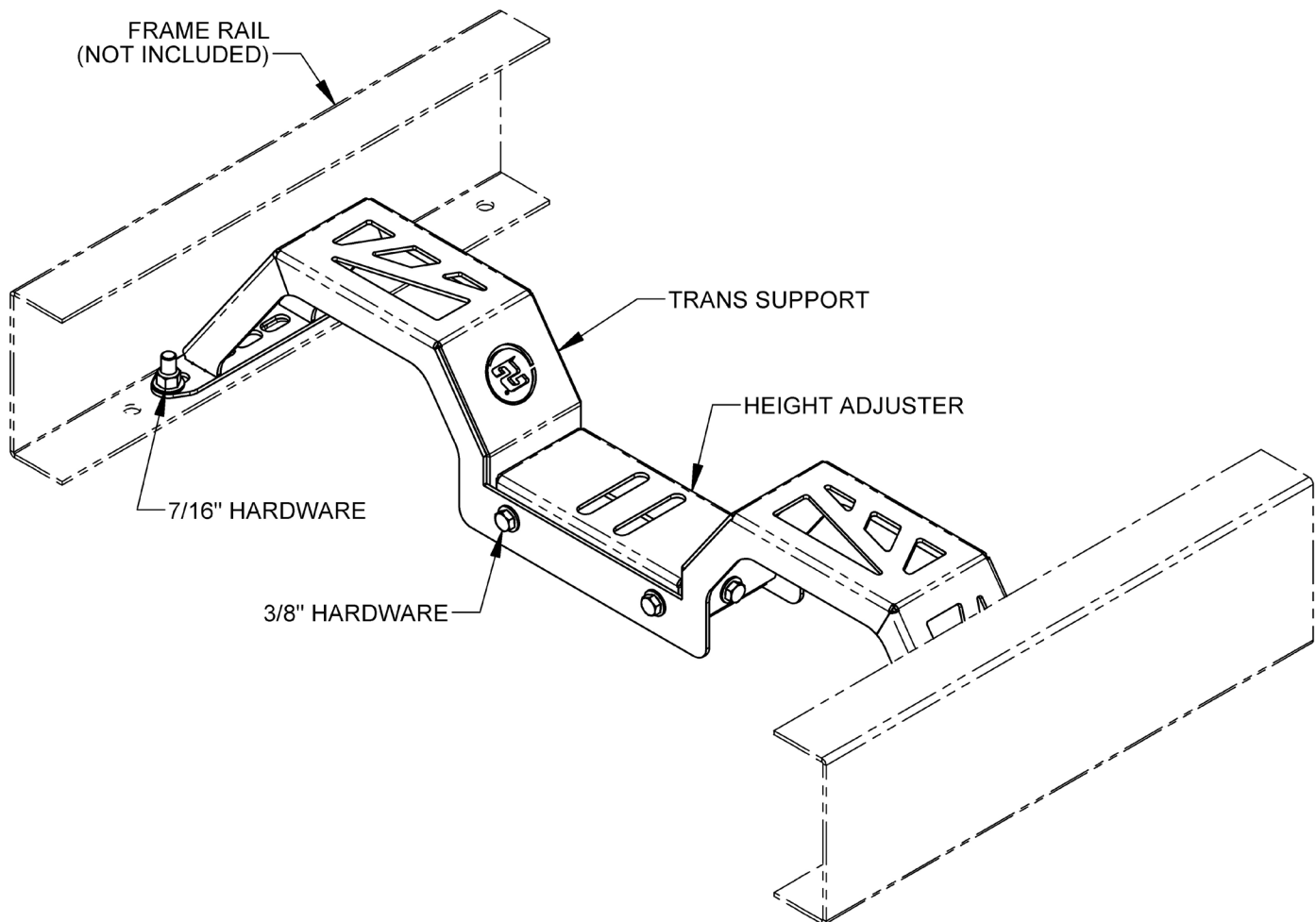

1. After the engine and transmission are installed, support the transmission at the correct angle.

## Setting the Transmission Angle -

### Level the Vehicle:

Ensure the vehicle is on a flat, stable surface and supported evenly on all sides.

### Measure Transmission Angle:

Use an angle finder on a flat surface of the transmission, such as the pan rail or output shaft housing. The angle should typically be 2-4° down toward the rear.

### Check Driveshaft and Pinion Angles:

Measure the driveshaft and pinion angles to ensure proper alignment with the transmission. They should be within 1-3° of each other.

### Adjust the Transmission:

Raise or lower the transmission by adjusting the height adjuster to achieve the correct angle. You may need to add spacers or shims to the mount depending on your specific application.

2. Determine the centerline of the transmission mount. Place the transmission support within the frame rails. Bolt the transmission support into existing frame holes that place the centerline of the support within 1" of either side of the transmission mount. Use the 7/16" bolts, washers and lock nuts to fasten to both frame rails.

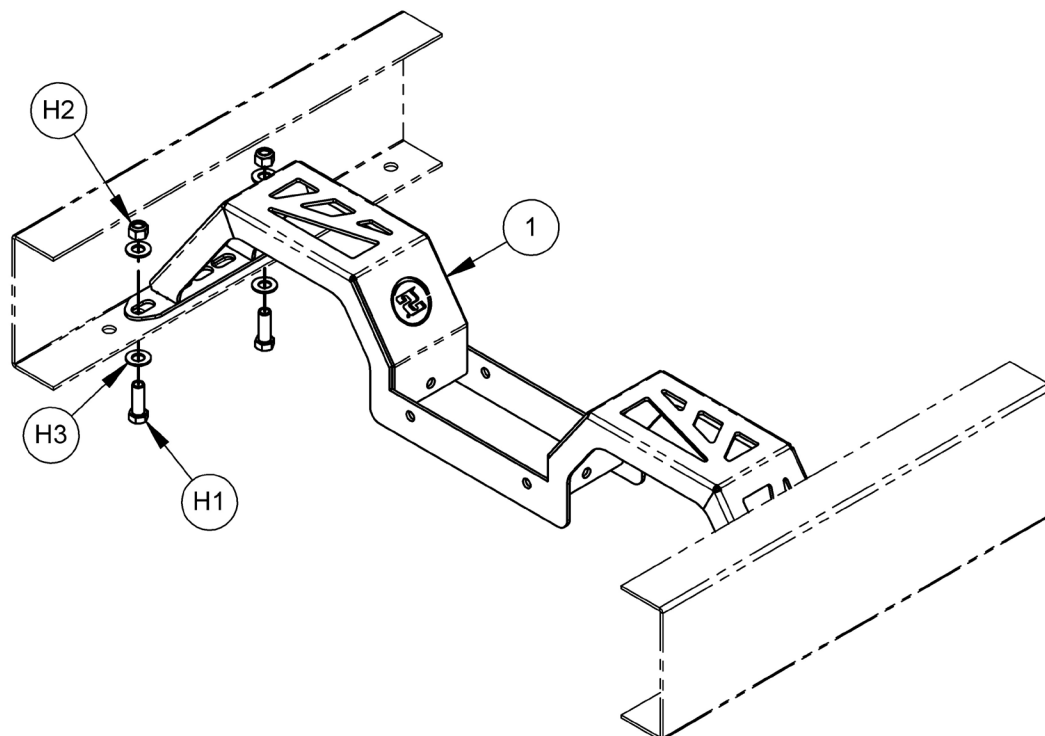

# INSTRUCTIONS



© 2025, Speedway Motors, Inc.

**3.** With the transmission still at the correct angle install the height adjuster from the bottom of the support until it touches the transmission mount. Determine which hole of the adjuster best aligns with support holes. Fasten the adjuster to the support using the 3/8" bolts, washers and lock nuts as shown below. Repeat for the other five locations.

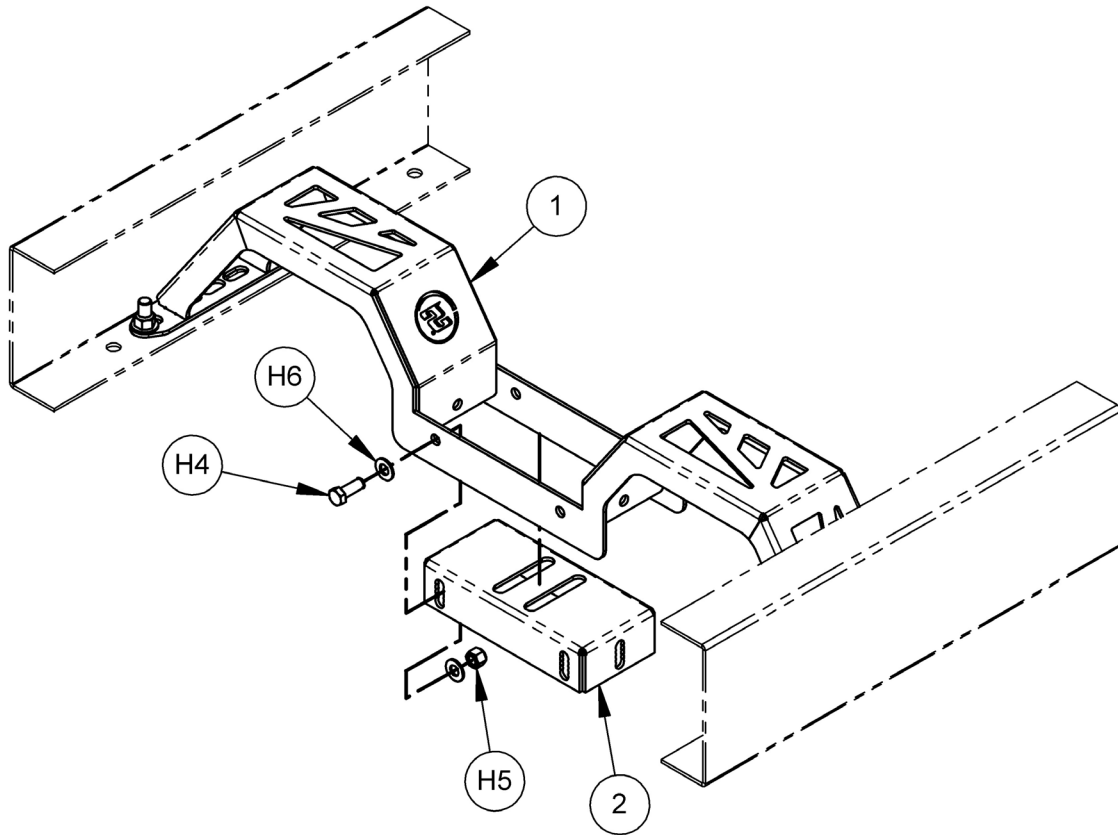

## Reverify the Transmission Angle:

After installation, it's important to recheck the transmission angle after a few hundred miles of driving. Components can settle over time, which may cause the angle to shift slightly. Adjust as needed to maintain proper alignment.

### Need Help with This Product?

Talk to one of our Tech Support Agents:

Mon-Fri, 8am - 5pm (CST)

**U.S.:** 800.979.0122

**Canada:** 855.313.9180

**International:** 1.402.323.3200