

INSTRUCTIONS

911-40233 Submersible Fuel Pump Module - Universal

©Speedway Motors, Inc. 2017

Note: This is a universal fuel pump module and must be cut to fit most applications.
This pump must be used with a “return” style fuel pressure regulator.

1. Choose the fuel pump location. The bottom and top of the fuel tank must be flat around the sump and mounting plate in order for the module to function properly.
2. Use a hole saw to cut a 4” diameter hole in the tank.
3. Measure the depth of the tank and cut the module bracket to the correct length. The sump should sit as close to the bottom of the tank as possible.
4. Assemble the sump and fuel pump brackets to the module as shown. Use two of the 3/4” long #10-32 screws, washers and steel nuts.
5. Test fit the module to check the depth. If the depth is correct, clock the module to the desired angle and use the module as a template to mark the location of the 16 mounting holes on the tank.
6. Remove the module and drill each hole to 1/4”. **Note:** Use a shop-vac while drilling to keep from getting metal shavings in the gas tank.
7. Install the AN-6 to hose barb fittings and 90 degree vent fitting into the top plate. (use thread sealant)
8. Install the pickup filter onto the bottom of the fuel pump and secure the pump using the large hose clamp. The filter should be just touching the bottom of the sump.
9. The supply and return hoses will need to be cut to length. Cut the return hose so the bottom is roughly 3/4” above the bottom of the sump and slide it onto the hose barb.
10. Cut the wires to length and install the ring terminals. It is recommended to solder these connections and use heat-shrink tubing. With the ring terminals soldered to the wires you can now assemble the terminal posts as shown. Be sure to put the positive (Red) wire in the (+) location and the ground (Black) in the (-) location.
11. With the module fully assembled, it is time to install the backing ring. First, glue the backing ring in place. Place a small amount of RTV on the top surface of the backing ring, and clamp it in place. Make sure that all of the holes are aligned! This will hold the ring in place while the module is being installed. **Note:** A dab between each hole should suffice as this does not need to seal. It only needs to hold the ring in place during installation.
12. Once the RTV has set up enough to hold the backing ring in place, you can now install the gasket and module. The gasket will go on top of the tank, between the tank and the top plate of the module. Get each screw started before fully tightening any screws. (use thread sealant on the screws) **Be sure the tank is completely clean and all metal shavings have been removed before final install!**
13. Connect the ground wire (14 AWG min.) to the (-) terminal and a power supply wire (14 AWG min.) to the (+) terminal. Larger wires will work as well. Route a breather hose to a ventilated area outside of the car, typically on the underside of the car. Rout the pressure hose to the “inlet” port on your fuel pressure regulator. Route the return hose to the “bypass” or “return” port on the pressure regulator.

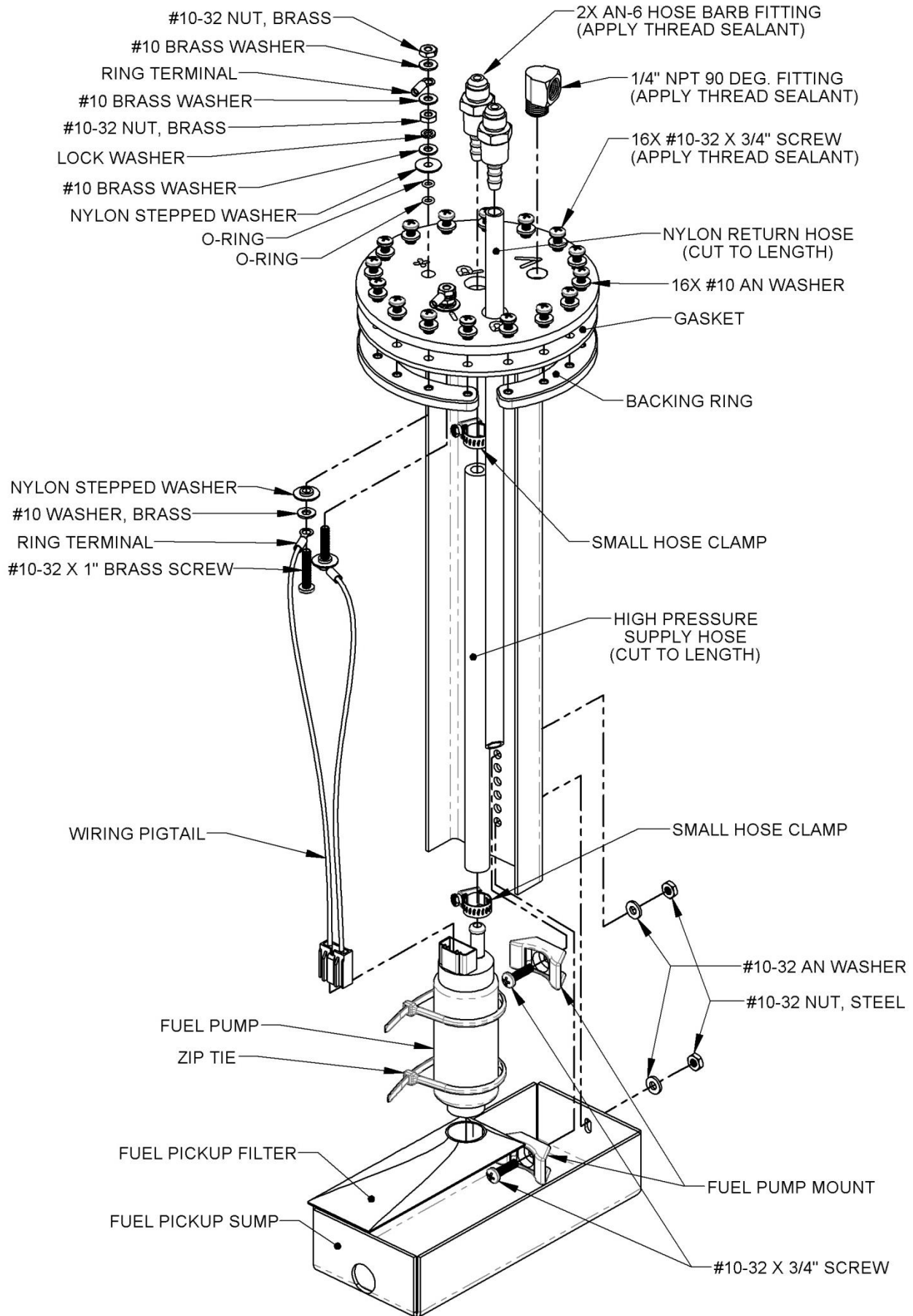

IMPORTANT

DISCLAIMER

In an effort to offer our customers the low prices, quick service and great value, Speedway Motors reserves the right to change suppliers, specifications, colors, prices, materials. Each of the previous items is subject to change without notice. Speedway is not responsible for any typographical errors or misinterpretations. Quantities are limited on some items.

WARRANTY DISCLAIMER

The purchaser understands and recognizes that racing parts, specialized street rod equipment, and all parts and services sold by Speedway Motors, Inc. are exposed to many and varied conditions due to the manner in which they are installed and used. Speedway Motors, Inc. makes no warranties, either express or implied, including any warranty of merchantability or fitness for a particular purpose other than those contained in its current catalog with respect to the goods identified on the face of the invoice. There is no warranty expressed or implied as to whether the goods sold hereby will protect purchaser or ultimate user of such goods from injury or death. Speedway Motors assumes no liability after this period.

BRAKE INSTALLATION ALERT

The selection and installation of brake components should only be done by personnel experienced in the proper installation and operation of braking systems. The installer must use his/her own discretion to determine the suitability of all brake components and brake kits for every particular application. Speedway Motors, Inc. makes no warranties either expressed or implied including any warranty of merchantability or fitness for a particular purpose, other than those contained in its current catalog or website with respect to the goods identified on the face of the invoice. There is no warranty expressed or implied as to whether the goods sold hereby will protect the purchaser or ultimate user of such goods from injury or death.

DAMAGE CLAIMS

Always inspect your package upon delivery. Inspect all packages in the presence of the delivery driver. The driver must note any damage. Ask the driver the Carrier's procedures for handling damage claims. You must hold the original box, packing material and damaged merchandise for inspection or the carrier will not honor the claim. Notify Speedway Motors customer service department for instructions on returning damaged goods. Speedway is not responsible if no notification is given within 5 days of receipt.

SHORTAGES

Always check the contents of your delivery to insure all the parts that you ordered were received. Please read the invoice. Double check all packing materials, small items may be wrapped inside with these products. Shortages may occur from damage to the box, so save all packing materials. Inspect the box for holes that would allow parts to fall out. If you are missing any item(s) be sure to check your invoice for back orders or canceled items before calling the customer service department. If Speedway has to split a shipment into multiple boxes, packages may be delivered on different days. You need to contact the customer service department within 5 days of delivery to assure the prompt replacement. Speedway Motors assumes no liability after this period.

REFUSALS

All refused COD customers will be billed a 15% restocking charge plus freight to and from the destination! If you have questions please contact Speedway's customer service department.

WARRANTY CLAIMS

If an item has a manufacturer's warranty as being free from defects we will exchange only. If the item has been used and you are requesting warranty work, this may take up to 30 days as warranty work is done by the manufacturer NOT Speedway Motors. If you have any questions please contact customer service.

RETURNS

Speedway wants you to be satisfied with your purchase. If within 30 days after you receive your shipment you are not satisfied, you may return the item for refund or exchange. All exchanged or returned merchandise must be in original factory condition with no modifications or alterations. Returned merchandise must include all packaging materials, warranty cards, manuals, and accessories. If the items being returned need to be repackaged there will be a re-packing charge. Re-pack the item in a sturdy box and include a copy of your invoice and complete the form on the back of the invoice. You must ship orders back **PRE-PAID. WE DO NOT ACCEPT COD SHIPMENTS.** All exchanges need to have reshipping charges included. Items that are returned after 30 days are subject to 15% restocking charges. All fiberglass returned will have 15% restocking charge. No returns on electrical parts, video tapes, and books. Absolutely no returns on special order or close out merchandise.

FREE CATALOGS

Speedway Motors offers FREE catalogs for Race, Street, Sprint and Midget, Sport Compact and Pedal Car Restoration.

Some items are not legal for sale or use in California on pollution controlled motor vehicles. These items are legal in California for racing vehicles only which may never be used upon a highway.

**Speedway Motors Inc.,
P.O. Box 81906 Lincoln, NE 68501
800.979.0122 SpeedwayMotors.com**

