

916-43237 - 1947-54 Chevy Pickup Rear Leaf Kit

Kit Contents		
Qty	Part #	Description
2	106-1060	Street Rod Shock - Black
2	545-85090.1	Spring Pad, 3" Axle
1	910-04754.4	Shock Mount Crossmember
2	910-33326-1	Shackle, 2-1/2" Wide
1	916-43237.3	Hardware Kit
2	910-43447	Leaf Spring
4	910-43801	U-Bolt, 8x3
2	910-43237.1	Rear Leaf Mount Bracket - 1 Each LH/RH
2	910-43237.2	Front Leaf Spring Bracket - 1 Each LH/RH
2	916-43510	Leaf Spring Mount Plate - 1 Each LH/RH

Note: It is highly recommended that the bed be removed from the chassis before installing this kit.

Begin by removing the rear axle assembly, stock leaf springs, shocks and brackets.

Remove the front stock spring mounts. Begin by grinding the rivets flush and centerpunching them. Drill each rivet through with a 3/16" drill and go up in size to 5/16". Next, drive the rivet out using a punch and hammer. If the rivet cannot be driven out, drill through to 3/8" taking care to keep the drill centered to avoid opening the hole too much as these holes will be used to locate the new brackets.

Install the leaf spring mount brackets to the frame rails using the 3 holes on the outside of the rail and 2 holes on the bottom (**Illustration 1**). The running board brackets may need to be modified to allow clearance if they interfere with the new mounts. Using 3/8 x 1-1/4" socket head bolts, washers and locknuts, fasten the mounts to the frame. The washer should go between the nut and the inside of the frame rail. In some cases, it may be necessary to drill through some of the holes for best alignment before the bolts will fit. Do not open the holes more than needed to accomplish this. The third hole on the bottom of the rail will need to be drilled out. Using the mount as a guide, drill this hole to 3/8" and bolt in place.

Remove the rear shackle mount brackets as before. The new shackle mounts are positioned under the rail with the flat edge facing the front of the chassis (**Illustration 2**). Bolt the mount to the chassis as before. Redrill the holes as required to allow for alignment. Note that the third bolt on the mount will require the bolt to be inserted from the top (inside frame rail) and the nut will be on the bottom.

Install the springs with the bushing end in the front mounts using the 1/2 x 4" bolts and locknuts leaving the rear of the springs loose. Using a floor jack, position the rear axle assembly into position over the leaf springs. Do not lower the axle assembly at this time. Install the bushings in the leaf spring eyes and the shackle mount. Install the

INSTRUCTIONS

© 2025, Speedway Motors, Inc.

SPEEDWAY
motors®

shackle pins into the bushings. Raise the rear of the leaf springs and attach the shackle plates over the pins and fasten using the supplied nuts.

Install the spring pads over the locating pins on the leaf springs (**Illustration 3**). Set the axle assembly on the leaf spring pads. Center the rear end and install the U-bolts and spring plates as shown using the included 1/2-20 nuts. Rotate the pinion up in the front to 5 degrees from the lower surface of the pads and weld the pads to the axle tube.

Position the upper shock mount crossmember as shown. Install the lower shock mount studs to the spring plates. Install the shocks using the lower studs and the upper bolts through the crossmember sleeves as shown (**Illustration 4**). Locate the crossmember in the frame so the shocks are vertical when viewing the chassis from the side. When the crossmember is centered and square in the chassis, clamp in position. Drill 8 holes through frame rail and crossmember saddles (2 top and 2 bottom on each side) and fasten using supplied bolts and nuts as shown.

Confirm that all fasteners are tight before attempting to move the vehicle.

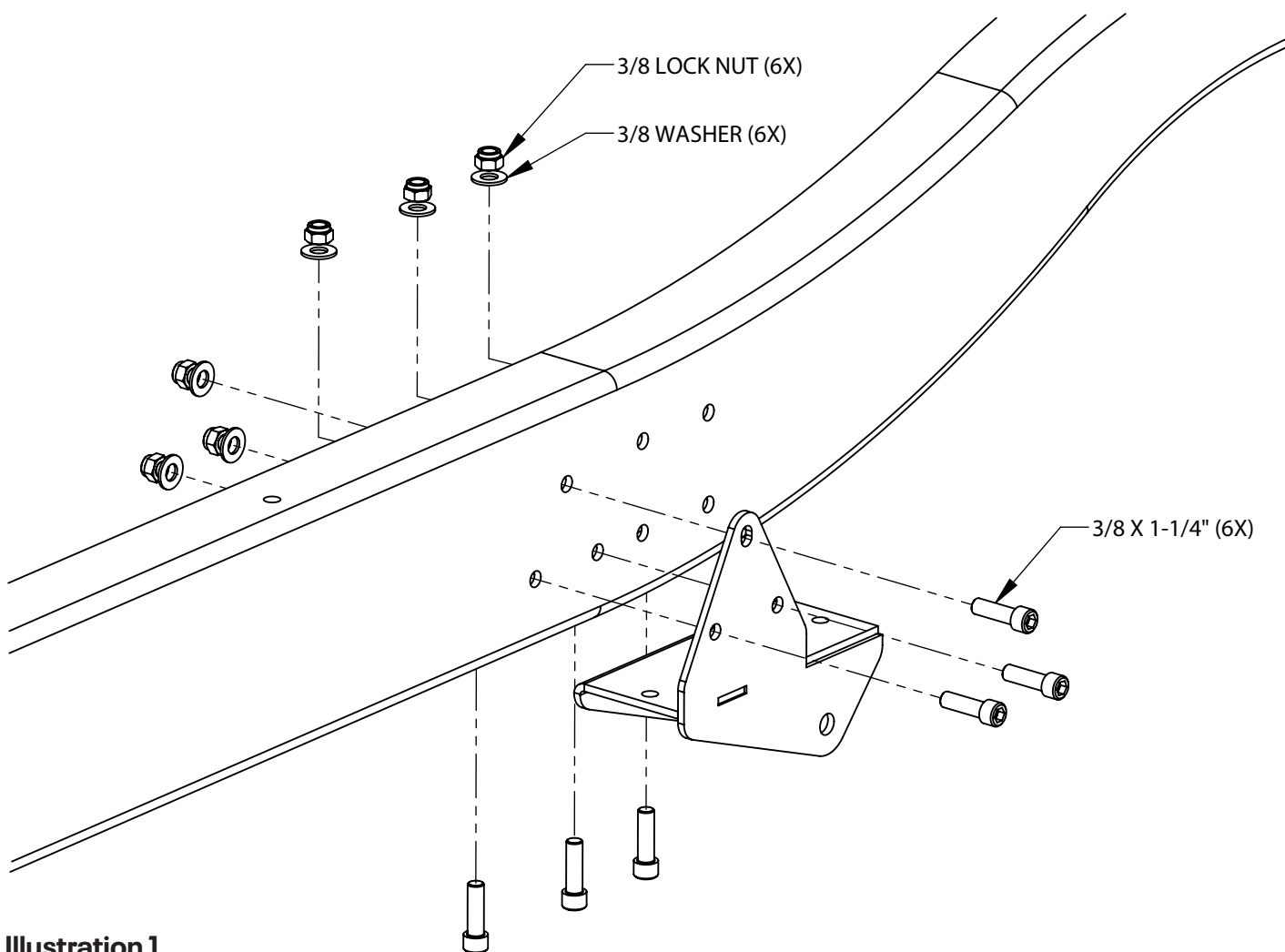

Illustration 1

INSTRUCTIONS

© 2025, Speedway Motors, Inc.

SPEEDWAY
motors®

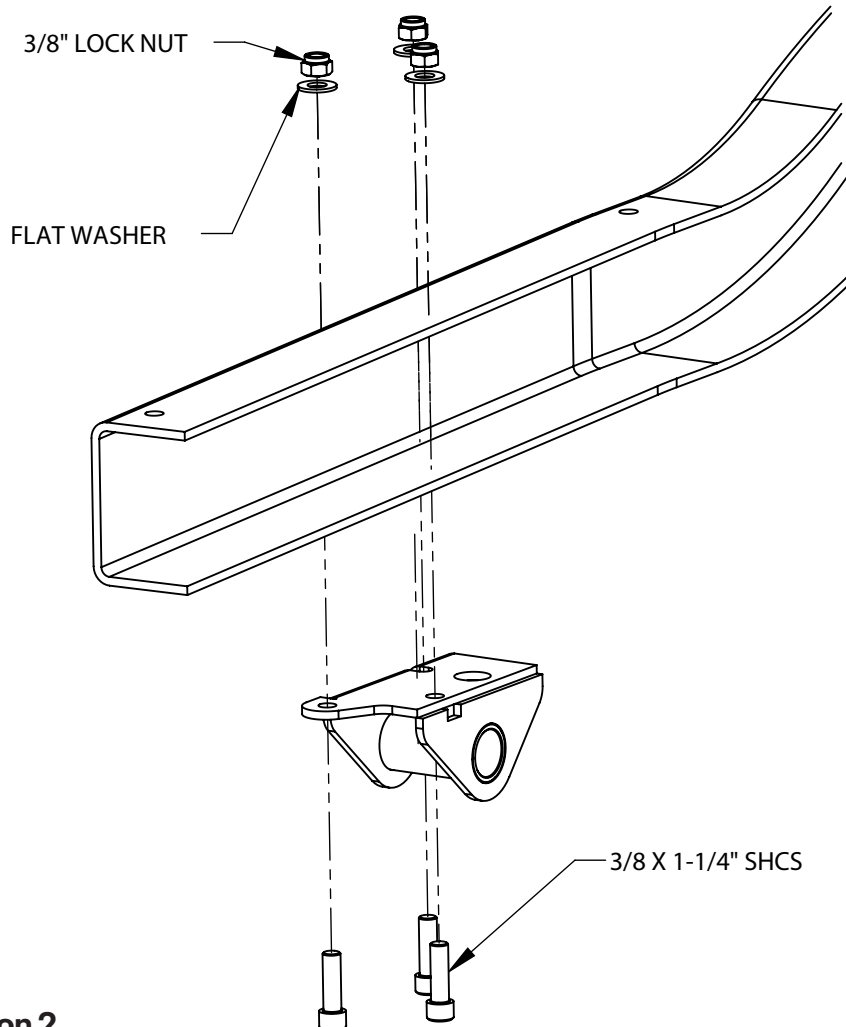

Illustration 2

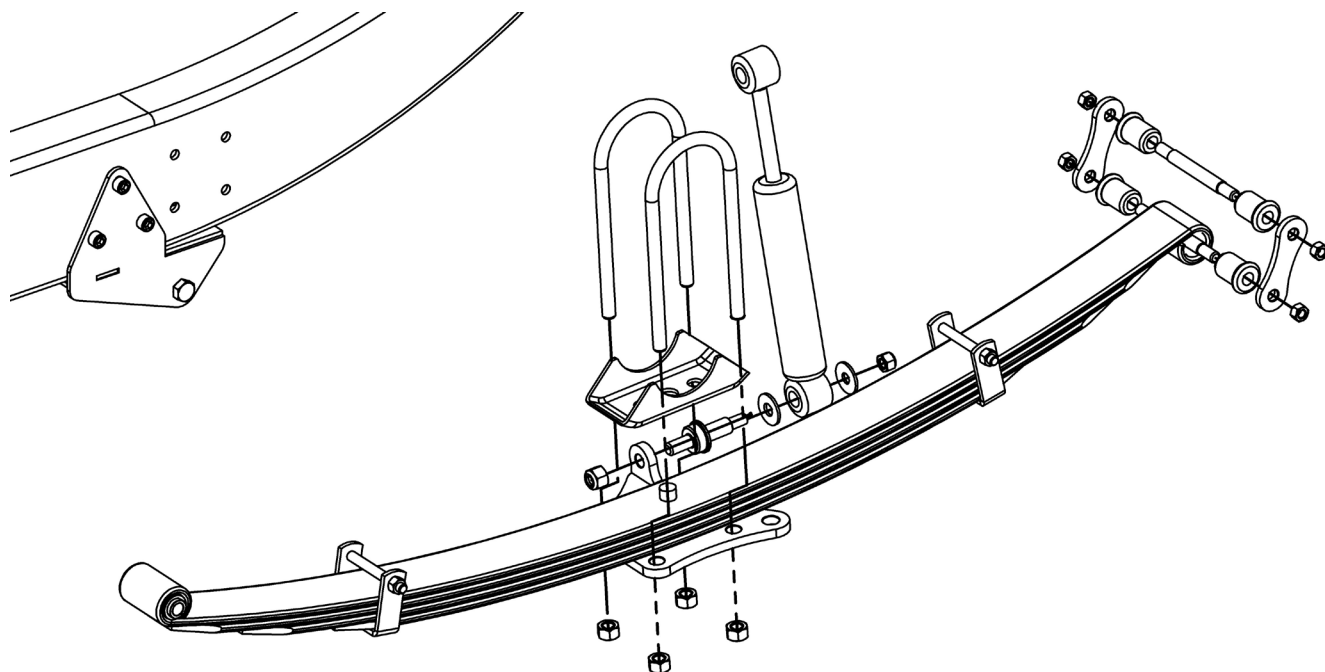

Illustration 3

INSTRUCTIONS

© 2025, Speedway Motors, Inc.

SPEEDWAY
motors®

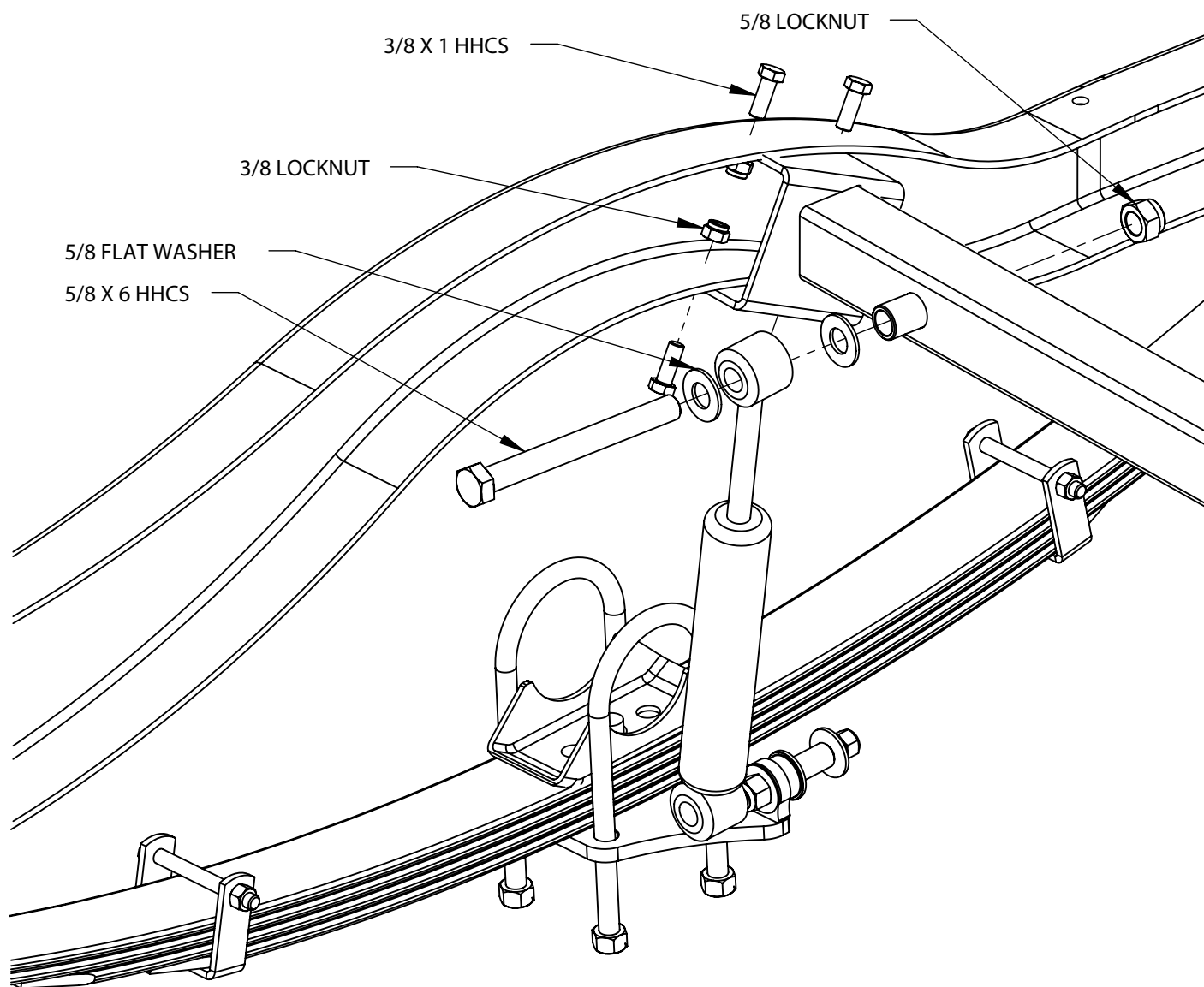

Illustration 4