

INSTRUCTIONS

© 2025, Speedway Motors, Inc.



916-69001 - 1973-80 Chevy C10 Hood Hinges

Kit Contents		
Qty	Part #	Description
1	91669001.12.L	Hood Hinge - Left
1	91669001.12.R	Hood Hinge - Right
10	HSSANFW-.38	Stainless AN Washer - 3/8"
10	HB8BSCSC-.38-1.00	Button Head Cap Screw, 3/8-16

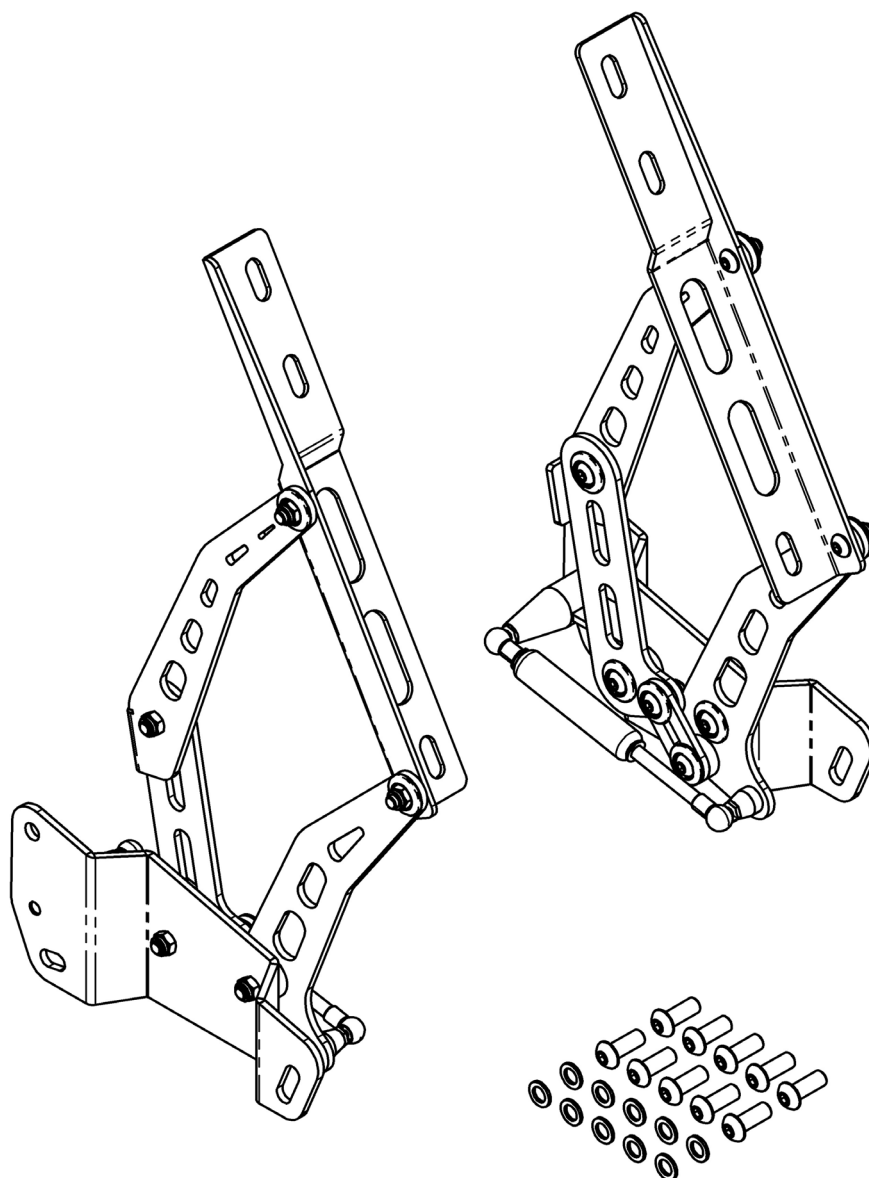

INSTRUCTIONS

© 2025, Speedway Motors, Inc.



1. The following procedures will require at least 2 people to accomplish. Remove existing hood from the original hinges. It is highly recommended that you apply painter's tape to all hood edges and cowl/fender areas where contact may be made during the installation and adjustment process to avoid paint damage. Adjusting the hood will take some time and trial and error. Patience will go a long way in avoiding damage to the vehicle.

2. Remove the factory hinges from the fenders.

3. NOTE: You will **NOT** be able to collapse the struts without first installing the hinges and using the hood for leverage. If hinge articulation is needed, the struts can be removed by releasing the wire clips from the rod ends and detaching the rod end sockets from the ball studs. However, this is typically not necessary.

Position each hinge on the matching fender, apply anti-seize to the threads, and secure with the provided 3/8-16 x 1" button head bolts and washers. Tighten the bolts to ensure a firm attachment to the fender.

Additional Note: The hood spring struts included in the kit are rated for a stock OE hood. Struts for lighter aftermarket hoods can be purchased separately.

4. Depending on your hood type, you may need a shorter bolt when attaching the hinge to the hood. To avoid damage to the hood, carefully check the length before installing completely and tightening. To make it easier to open and close the hood during adjustments, it is recommended that you temporarily remove the hood latch from the hood. Attach the hood to the hinges using the supplied 3/8-16 x 1" bolts and a flat washer. Be sure to use anti-seize on all bolts before installing. The supplied struts are set for the weight of an OEM type steel hood.

5. To avoid contacting the cowl when closing the hood for the first time, slide the hood as far forward as possible before closing. Close the hood carefully making sure it does not hit the fenders or cowl.

6. Check the height and position of the hood. Make any adjustments by repositioning the hinge slightly at the hood or fender locations. Note that some installations may take considerably more time than others to properly adjust.

To correct hood height, adjust at the fender plate. To correct front to back location, adjust at the hood plate. To correct left to right, adjust at hood plate. Do not attempt to modify the slotted holes to adjust the alignment as this will void any warranty.

7. Once the hood position has been finalized, securely tighten all bolts, re-install and adjust the hood latch and remove painter's tape.